

Sun State Components Helps Expand Pawn Stars



by Libby Maurer

Popular Las Vegas pawn shop gets an addition with help from SBCA member.

Las Vegas: glitz, gambling, and home to the Gold and Silver Pawn Shop. History Channel buffs will recognize this nondescript landmark from the hit series *Pawn Stars*. The reality show captures a husky (and entertaining) grandfather-son-grandson trio who operate a booming pawn business on The Strip. The format is straightforward: Richard, Rick and Corey Harrison are taped dealing with potential sellers looking to pawn all manner of items. (As an example, one episode features a peg leg...) The show reveals the real business of running a pawn store, whether it's appraising odd items or spotting stolen goods.



"It was a really nice project for us. We knew a lot of people would be looking at it so we took advantage of the marketing opportunity."

—Art Ramirez

When the show began its third season in June, fans were ecstatic. But by then, it had gained such a following that tourists were lining up to see Gold and Silver in person. Folks who had already visited the shop report it desperately needed an expansion. "They seriously need to expand their showroom, and fast!" one blogger wrote.

Expand they did, and Sun State Components supplied the roof and floor systems for Gold and Silver's 6,000 square foot addition. Sales manager Art Ramirez said since the original building is located in "old" Las Vegas, it took the city several months to make sure the two-story addition would measure up to new building codes. The bottom floor will be used to store excess inventory, while the second level is dedicated to office space. Despite the massive new space, Gold and Silver shoppers will not have access to it. "The expansion is definitely bigger than their showroom, but they're not using it for extra retail space," he said.

Truss designer Rich Menge said although the addition is large, the design is quite simple. "There were only about six designs total for the roof and floors," he said, noting that the tapered flat roof trusses and floor trusses span 42'. Long-time customer Don Herman Construction of Las Vegas asked Sun State to be the truss supplier. "A lot of our work is based on long-term relationships that we've worked hard to maintain," Ramirez said. Westcor Framing (also of Las Vegas) was the framing contractor.

Because of the high profile nature of this job, Sun State made sure to maximize its exposure with a banner hung on one of the trusses. "It's a good way to market our company. You know, The Strip is a great place to advertise," said Ramirez. **SBC**

See pages 18-19 for additional photos of the project. For more information about *Pawn Stars* on the History Channel, including downloads of full episodes, visit www.history.com/shows/pawn-stars.



PENNSYLVANIA LUMBERMENS MUTUAL
INSURANCE COMPANY

Since 1895, we've been insuring companies and family businesses like yours.

Tomorrow... we will do the same!

At PLM, we understand that you need an insurance company with property and casualty insurance products and services that you can trust.

For over 100 years, our experts have been providing quality claims and risk management services to the lumber, woodworking and building material industries. Remember, "you get what you pay for." We understand wood. We know your business... because it's our business too.

If you're looking for quality and value from your insurance provider, please contact the PLM Marketing Department at 800.752.1895 or log onto www.plmins.com.

Yesterday, Today, Tomorrow... grow knowing you're covered.

John Smith

John K. Smith, CPCU
President and Chief Executive Officer

wood is all we do.

Pennsylvania Lumbermens Mutual Insurance Company
One Commerce Square, 2005 Market Street, Suite 1200
Philadelphia, PA 19103

S E R V I N G C O N T I N E N T A L U N I T E D S T A T E S

For reader service, go to www.sbcmag.info/plmins.htm

Sun State Components supplied the roof and floor systems for Gold and Silver's 6,000 square foot addition. There were about 6 designs for the roof and floors. The tapered flat roof trusses and floor trusses span 42'.



"A lot of our work is based on long-term relationships that we've worked hard to maintain."

—Art Ramirez



MASENGILL MACHINERY CO.

Production Machinery Specialists Since 1963

New • Used • Refurbished • Reconditioned

Over 50,000 sq. ft. warehouse filled with equipment to meet your needs:

1 - ADT "FASTRAC" Bridge Nailer	5 - Klaisler Powered Outfeed Roller Systems	with Koskovich Jet-Set Automation Hardware
1 - Alpine 14'6" Finish Roller	2 - Koskovich Auto-OMNI, 5 Heads with Ink Jet Printer	1 - Pacific Automation Floor Gantry w/Auto-Stacker
4 - Alpine Model 725D Finish Rollers (15'6")	1 - Mango Tech "Wall Extruder" 2006	1 - Paslode Model CN70 Sub Component Nailer
1 - Alpine Speed Roll TW Floortruss Machine	30 - Material Handling Carts (Steel)	1 - Robbins Valley Set Shaper
1 - ASI FWA-500 Floor Web Saw	2 - Monet B500 Component Saws	1 - Robbins 7 Station Lumber Carousel
5 - ASI Stretch Roller Bed Trailers	2 - Pacific Automation Auto 8's	1 - Speedcut MetraCut w/Mango Automation
1 - ASI Roller Bed Trailer	2 - Pacific Automation 5 Strand Live Decks	1 - Speedcut EWC Web Saw
2 - Clary 329 Short Cutters II	4 - Pacific Automation Auto-Roll 14TR Gantry Rollers	1 - Spida Model CXTM R/A Saw with Hain Measuring System
1 - EMSI Model #305 20' Lumber Conveyor	1 - Pacific Automation Auto-Roll 14' capacity	1 - TCT Model 1150 w/ Mathews Ink Jet System (2005)
60 - Factory Wagons	2 - Pacific Automation 125' J-Slot Gantry Lines	1 - Weima Model 1300 "TIGER" Wood Grinder
1 - Jager TTS Auto Stacker		
1 - Klaisler Ro/Splice Machine		
2 - Klaisler G2450 Floor		

TCT Model 1150 w/ Mathews Ink Jet System

1002 Buffalo Trail • Morristown, TN 37814
Office: (888)USE-WOOD (873-9663)
Fax: (423)586-0483
info@masengills.com

www.masengills.com

For reader service, go to www.sbcmag.info/masengill.htm



AUCTIONEERS // LIQUIDATORS // APPRAISERS

ONLINE AUCTION

STARTING: DECEMBER 9 – ENDING: DECEMBER 16, 2010

CENTURY TRUSS COMPANY

7600 KENSINGTON CT, BRIGHTON, MI 48116

INSPECTION: DECEMBER 9TH, 9:00 AM – 5:00 PM EST



TRUSS MACHINES: 1999 TEE-LOK 50' FLOOR TRUSS MACHINE; 1995 TEE-LOK 40' FLOOR TRUSS MACHINE; **CUSTOM BUILT** 4' X 14' TRUSS ASSEMBLY LINE; TEE-LOK 6' X 14' TRUSS ASSEMBLY LINE; TEE-LOK 6' X 14' TRUSS ASSEMBLY LINE; TEE-LOK 6' X 14' TRUSS ASSEMBLY LINE

LASER SYSTEMS: 7) VIRTEK TRUSSLINE LASER SYSTEMS

WEB SAWS: 2) 1998 MITEK MODEL 700000/2000 EASY-SET 4 HEAD WEB SAWS; 1994 MITEK MODEL 7048500 EASY-SET 4 HEAD WEB SAW

BAND SAW, RADIAL ARM SAWS, TRUCKS, TRAILERS, BOOM LIFT, TRUCK CRANE, INVENTORY, FORK LIFTS AND MUCH MORE

VISIT OUR WEBSITE FOR FULL DETAILS, PHOTOS & TO

BID:

WWW.RJMAUCTIONS.COM



For reader service, go to www.sbcmag.info/rjm.htm

Let's Build Wall Panels Together!

ITWBCG has tools that save you time and money.

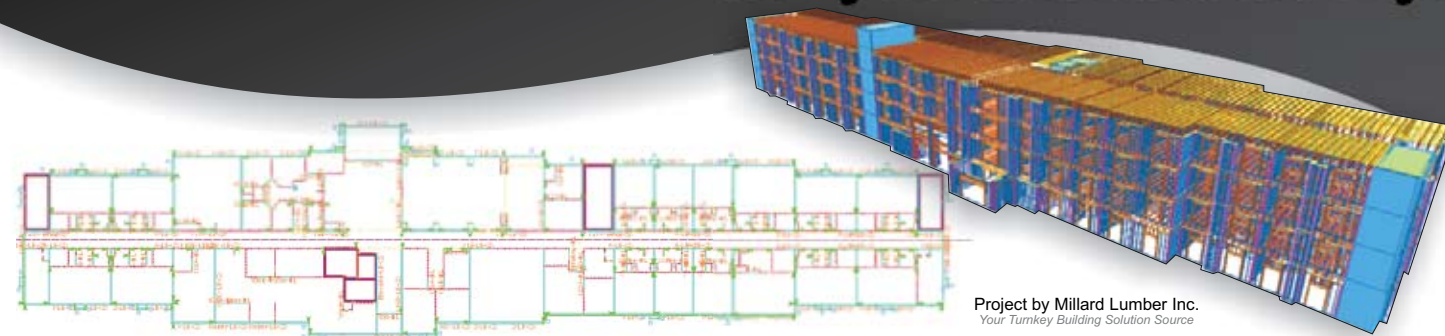

Project by Millard Lumber Inc.
Your Turnkey Building Solution Source

- **Save time!** Your designers will work smarter using "Parametric cut and paste" with **Binder**.
- **Go Green & save money!** Optimize with **WallBatch** to make the most of your raw materials.
- Connect with **ITWBCG's Building Design Platform** for true industry-wide interoperability.
- See our full line of **Fasteners** and **Plant Equipment** for Wall Panels & Trusses.



www.itwfpfs.com



intelligentBUILDINGSYSTEMS™

www.intelbuildsys.com



EQUIPMENT
A Division of ITW Building Components Group Inc.

www.alpineequip.com

ITWBCG Equipment • 2820 N. Great Southwest Parkway • Grand Prairie, TX 75050 • 800-755-6005

For reader service, go to www.sbcmag.info/tbs.htm

STRUCTURAL BUILDING COMPONENTS™

THE FUTURE OF FRAMING

www.sbcmag.info

Dear Reader:

Copyright © 2010 by Truss Publications, Inc. All rights reserved. For permission to reprint materials from **SBC Magazine**, call 608/310-6706 or email editor@sbcmag.info.

The mission of **Structural Building Components Magazine (SBC)** is to increase the knowledge of and to promote the common interests of those engaged in manufacturing and distributing of structural building components to ensure growth and continuity, and to be the information conduit by staying abreast of leading-edge issues. SBC will take a leadership role on behalf of the component industry in disseminating technical and marketplace information, and will maintain advisory committees consisting of the most knowledgeable professionals in the industry. The opinions expressed in SBC are those of the authors and those quoted solely, and are not necessarily the opinions of any affiliated association (SBCA).



6300 Enterprise Lane • Suite 200 • Madison, WI 53719
608/310-6706 phone • 608/271-7006 fax
www.sbcmag.info • admgr@sbcmag.info