

Parting Shots

Share your stories and photos with us! Send submissions to partingshots@sbcimag.info.



The members of the SBCA's Texas Chapter, the Truss Manufacturers Association of Texas (TMAT), work hard every year to make sure they bring home the #1 Chapter trophy in the SBCA Annual Membership Drive. Showing off their TMAT pride, attendees of their September golf outing and dinner meeting gathered 'round for this photo with the marble trophy.

Coming as no surprise, the chapter pulled off an eleventh-hour victory in the 2010 Membership Drive too—after this meeting, the trophy was headed back to the engraver to have the chapter's name etched onto the column for the eighth time! **SBC**



KOSKOVICH
COMPANY
Automation that works.™

Wall Framing Made Simple...

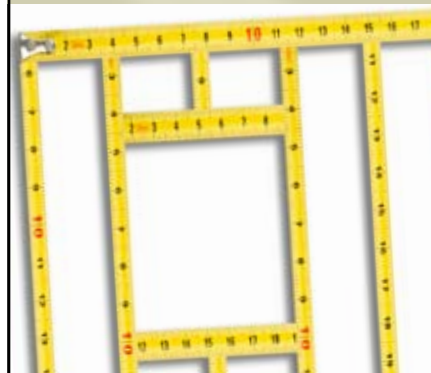

PLUS
PANELS
STENELS

Success is measured only one way — by the components you build

With our reputation for building machinery "that works" and our master design capabilities you can be assured Panels Plus equipment will increase your production.

- Low budget multi function single table (requires little shop floor space)
- Custom length tables for long walls. Interior/exterior fastening options (nails, staples, screws)
- Custom built bridge over your existing table
- Tilt table with both side access (near vertical positioning)
- Floor section tables (adjusts from 6' to 16', up to any length)
- Steel stud tables (inquire)
- Sub component nailer (builds 8 different wall sub components)
- Mount any brand of nailer, stapler, screw gun (on most any machine)
- Material Handling carts (extra heavy duty)

For information call Tim Kaasa
866.726.7587 or www.panplus.com

For reader service, go to www.sbcmag.info/panelsplus.htm

REACH FOR EXCELLENCE

Take Your Plant to New Heights with SCORE



"In order to succeed, our customers need to know they can count on us to provide what's needed. Working with SBCA and becoming SCORE certified proves we are committed to excellence."

— Steve Kennedy, Engineer/Training Manager, Lumber Specialties

Set your company apart with SCORE's certification program that incorporates all of SBCA's education and training programs – helping you implement cost-effective industry best practices. Learn more about options and how to get started at www.sbcindustry.com/score.php.



SCORE Elite

ProBuild Manufacturing

www.probuild.com

Anchorage, AK	Norcross, GA	Clackamas, OR
Big Lake, AK	Pooler, GA	Mitchell, SD
Chugiak, AK	Hawarden, IA	Buda, TX
Kenai, AK	New Hampton, IA	Carrollton, TX
Phoenix, AZ	Indianapolis, IN	Mercedes, TX
National City, CA	Valley Center, KS	West Point, VA
Dolores, CO	Dry Ridge, KY	Auburn, WA
Longmont, CO	Wadena, MN	Walla Walla, WA
Lady Lake, FL	Albemarle, NC	West Richland WA
Milton, FL	Albuquerque, NM	Spokane, WA
Plant City, FL	Berlin, NJ	De Pere, WI
	Delaware, OH	

Shelter Systems Limited

www.sheltersystems.com • Westminster, MD

Sun State Components of Nevada, Inc.

www.sunstatenv.com • North Las Vegas, NV

SCORE Leaders

Capital Structures

www.capstructures.com
Fort Smith, AR

Dakota Craft Truss

www.dakotacraft.com
Rapid City, SD

Lumber Specialties

www.lbrspec.com
Dyersville, IA • Story City, IA

Plum Building Systems, LLC

www.plumbuildingsystemsinc.com
West Des Moines, IA

True House, Inc.

www.truehouse.com
Jacksonville, FL

Truss Craft

www.trusscraft.com
Cheyenne, WY

SCORE Achievers

Latco Structural Components

www.latcoinc.com
Lincoln, AR

Tri-County Truss, Inc.

www.tricountytruss.com
Burlington, WA

Truss Systems, Inc.

www.trussystemsinc.com
Oxford, GA

CONNECT →

with ITW's Building Design Platform

It has been estimated that a typical structure is completely redrawn by construction professionals as many as seven times before it is ever built! Industry experts agree that designers could save as much as 30 to 60 percent of design time by building on work already done - rather than restarting each step from a blank page. Clearly, bringing the industry together would speed the overall process and help create more end-user value. So what is the solution? Instead of offering a one-size-fits-all program that does everything for everyone - it makes more sense to build tools that allow professionals to work together and keep the programs they need to do their specialized jobs. By collecting the output of all design work into one three-dimensional file we could cut design time substantially and all but eliminate field surprises. The resulting 3D file would be a virtual proof of the finished building!

The good news is that ITW BCG began work on this project years ago, and has solutions in place so that you could help lead this revolution - RIGHT NOW. ITW BCG software ties the industry together using our 3D file exchange format called ModelMap. It also gives designers the additional benefit of real-time exchange of model information between ITW BCG programs. That allows ITW Customers to work faster and add even more value.

Call us today to see how you can save time and money!



ITW BCG demonstrated our software's interconnectivity at the 2010 BCMA show.

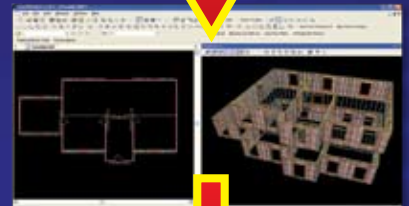
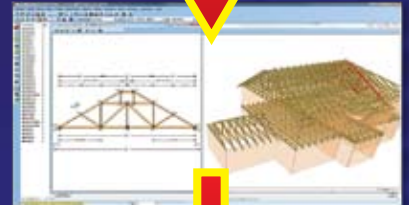
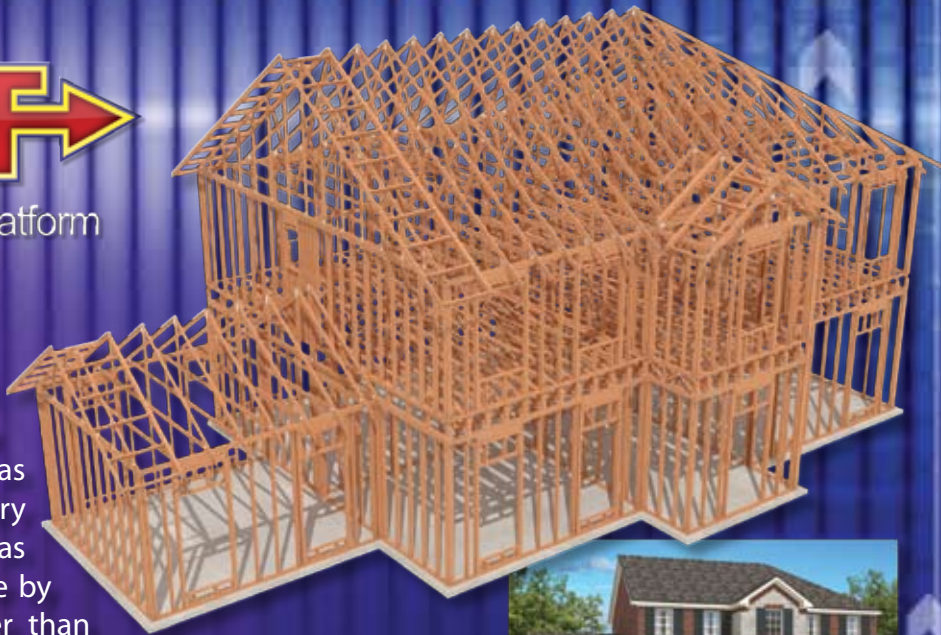

ITW Building Components Group

800.521.9790 - www.itwbcg.com

For reader service, go to www.sbcmag.info/itw.htm

STRUCTURAL BUILDING **COMPONENTS**TM

THE FUTURE OF FRAMING

www.sbcmag.info

Dear Reader:

Copyright © 2010 by Truss Publications, Inc. All rights reserved. For permission to reprint materials from **SBC Magazine**, call 608/310-6706 or email editor@sbcmag.info.

The mission of **Structural Building Components Magazine (SBC)** is to increase the knowledge of and to promote the common interests of those engaged in manufacturing and distributing of structural building components to ensure growth and continuity, and to be the information conduit by staying abreast of leading-edge issues. SBC will take a leadership role on behalf of the component industry in disseminating technical and marketplace information, and will maintain advisory committees consisting of the most knowledgeable professionals in the industry. The opinions expressed in SBC are those of the authors and those quoted solely, and are not necessarily the opinions of any affiliated association (SBCA) .



6300 Enterprise Lane • Suite 200 • Madison, WI 53719
608/310-6706 phone • 608/271-7006 fax
www.sbcmag.info • admgr@sbcmag.info