

Parting Shots

Share your stories and photos with us! Send submissions to partingshots@sbcmag.info.

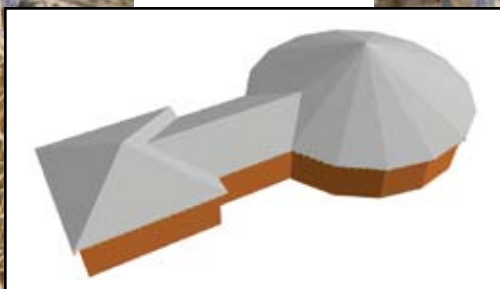

Daniel Snell, truss technician at Niagara Truss & Pallet in Lockport, NY submitted these shots of a 16-sided single-family home located in Basom, NY. Snell designed the roof trusses for the project.

Each of the 16 roof planes are sloped identically. A single girder truss spans the diameter of the home and ties into a steel pole set in the center of the "roundhouse." Snell said the home owners wanted a very distinct vault inside the home (as well as outside). So eight planes on one side of the girder have interior vaults parallel to the roof planes.

The ceiling plane on the opposite side of the girder is flat. Each wall in the roundhouse measures 8'7", with the exception of two shorter walls that lead to a breezeway connecting the house to the garage. "My boss calls [the house] the Starship Enterprise," he laughed.

"[The design] took a lot of preliminary work with the architect and framer," Snell said, noting that his company has strong relationships with local architectural firms. "They look to us to solve design challenges like this." **SBC**

Learn, Connect, Grow...



BCMC 2009 • September 30 - October 2

SOAR TO NEW HEIGHTS

"Each time you attend BCMC, you always learn something new. If you go there with an open mind, even if you don't think you are going to learn something, you do. Every year I learn something new. If it's not at the show it doesn't exist, right? You don't go to the show to find things, you go to the show with an open mind and they find you, every time."

J.R. Greer, President,
Montgomery Truss & Panel, Inc.
(BCMC 2008)

Mark your calendars and watch for your
BCMC Attendee Information coming soon.

PHOENIX
CONVENTION CENTER

For additional information or to register now go to www.bcmcsow.com

BUILDING SYNERGY

The key to building success is the relationship between all the parts and all the players - working together to get the ball rolling, building trust, Building Synergy.

We are the ITW Building Components Group, all the brands you have trusted for years working together to provide everything you need with outstanding products and services and expert support every step of the way.



Call us to see how we can help you
connect all the dots from the first design step, to engineering, to fabrication and beyond.

ITW Building Components Group

800.735.8055 | www.itwbcg.com

Truss Software - Engineering - Connectors	Truss Cutting & Fabrication Equipment	Wall Panel Software & Equipment	Canadian Products & Services	Trimable Floor Truss System	Cold-formed Steel Truss System	Architectural Design Software	Design & Manufacturing Software	Truss Fastening Systems	Wall Panel Fastening Systems
Connector Division 800.521.9790 itwbcg.com	Alpine Equipment 800.755.6005 alpineequip.com	Intelligent Building Systems 866.204.8046 intelbuildsys.com	Alpine Systems 905.417.2766 alpinetech.com	SpaceJoist TE 800.238.8678 spacejoist.com	TrusSteel 888.565.9181 trussteel.com	Ameri-CAD VisionREZ 972.747.7880 visionrez.com	hsbCAD 514.428.1444 hsbcad.com	ITW Industrial Fastening 888.386.3278 itwindfast.com	Panel Fastening Systems 888.726.3577 itwpls.com

For reader service, go to www.sbcmag.info/itw.htm

STRUCTURAL BUILDING **COMPONENTS**TM

THE FUTURE OF FRAMING

www.sbcmag.info

Dear Reader:

Copyright © 2009 by Truss Publications, Inc. All rights reserved. For permission to reprint materials from **SBC Magazine**, call 608/310-6706 or email editor@sbcmag.info.

The mission of **Structural Building Components Magazine (SBC)** is to increase the knowledge of and to promote the common interests of those engaged in manufacturing and distributing of structural building components to ensure growth and continuity, and to be the information conduit by staying abreast of leading-edge issues. SBC will take a leadership role on behalf of the component industry in disseminating technical and marketplace information, and will maintain advisory committees consisting of the most knowledgeable professionals in the industry. The opinions expressed in SBC are those of the authors and those quoted solely, and are not necessarily the opinions of any affiliated association (SBCA) .



6300 Enterprise Lane • Suite 200 • Madison, WI 53719
608/310-6706 phone • 608/271-7006 fax
www.sbcmag.info • admgr@sbcmag.info